



YOUR eSIM HAS ARRIVED!

CHECK THE STEP BY STEP
FOR USING YOUR eSIM



[CONFIGURE →](#)

BEFORE SCANNING THE QR CODE, PLEASE REMOVE THE PHYSICAL SIM CARD, OR DEACTIVATE THE PLAN OF YOUR PHYSICAL SIM CARD OR eSIM FROM BRAZIL TO AVOID NETWORK CONFLICTS AND ISSUES WITH THE eSIM INSTALLATION.



PROCEDURES FOR ACTIVATING YOUR eSIM

YOU NEED TO SCAN THE QR CODE 24 HOURS BEFORE ACTIVATION. WE RECOMMEND DOING THIS PROCEDURE ONE DAY BEFORE YOUR TRIP SO THAT YOU CAN USE YOUR HOME WI-FI FOR INSTALLATION. IF YOU HAVE ANY QUESTIONS, YOU CAN CONTACT OUR SUPPORT.

- 📱 OPEN THE CAMERA APP AND SCAN THE QR CODE.
- 📱 TAP ON THE "CELLULAR PLAN DETECTED" NOTIFICATION WHEN IT APPEARS.
- 📱 TAP CONTINUE AT THE BOTTOM OF THE SCREEN.
- 📱 TAP "ADD CELLULAR PLAN".



SUPPORT THROUGH WHATSAPP: +55 27 9 9958-8715

REST ASSURED THAT EVEN IF YOU SCAN THE QR CODE ONE DAY BEFORE, YOUR ESIM WILL BE ACTIVATED ON THE SCHEDULED DATE. IF AUTOMATIC ACTIVATION DOES NOT OCCUR, YOU CAN ACTIVATE IT MANUALLY USING THE QR CODE.

ANDROID

BEFORE SCANNING THE QR CODE, PLEASE REMOVE THE PHYSICAL SIM CARD OR DEACTIVATE THE eSIM FROM BRAZIL TO AVOID NETWORK CONFLICTS AND INTERFERENCE WITH THE VIRTUAL SIM INSTALLATION.

eSIM INSTALLATION

TO ACTIVATE E-SIM FUNCTIONALITY ON SAMSUNG PHONES, YOU NEED TO ACCESS THE DEVICE'S CONNECTION SETTINGS AND THEN SET UP A CORRESPONDING PLAN WITH YOUR CARRIER.

WITHIN THE CONNECTION SETTINGS, SIMPLY SELECT "SIM CARD MANAGER" AND THEN SCAN THE QR CODE PROVIDED BY CHIP2GO, WHEN AVAILABLE.

1
Access your device settings.

2

Go to the SIM card management area.

3

Add your new e-SIM plan.

4

Scan your QR code and you're done! Your connection will be activated.

BEFORE SCANNING THE QR CODE, PLEASE REMOVE THE PHYSICAL SIM CARD OR DEACTIVATE THE eSIM FROM BRAZIL TO AVOID NETWORK CONFLICTS AND INTERFERENCE WITH THE VIRTUAL SIM INSTALLATION.

1 eSIM INSTALLATION

INSTALL YOUR eSIM A FEW HOURS BEFORE YOUR TRIP OR THE DAY BEFORE. BEFORE TRAVELING, ENSURE YOUR IPHONE IS CONNECTED TO WIFI OR MOBILE DATA TO INSTALL THE eSIM.

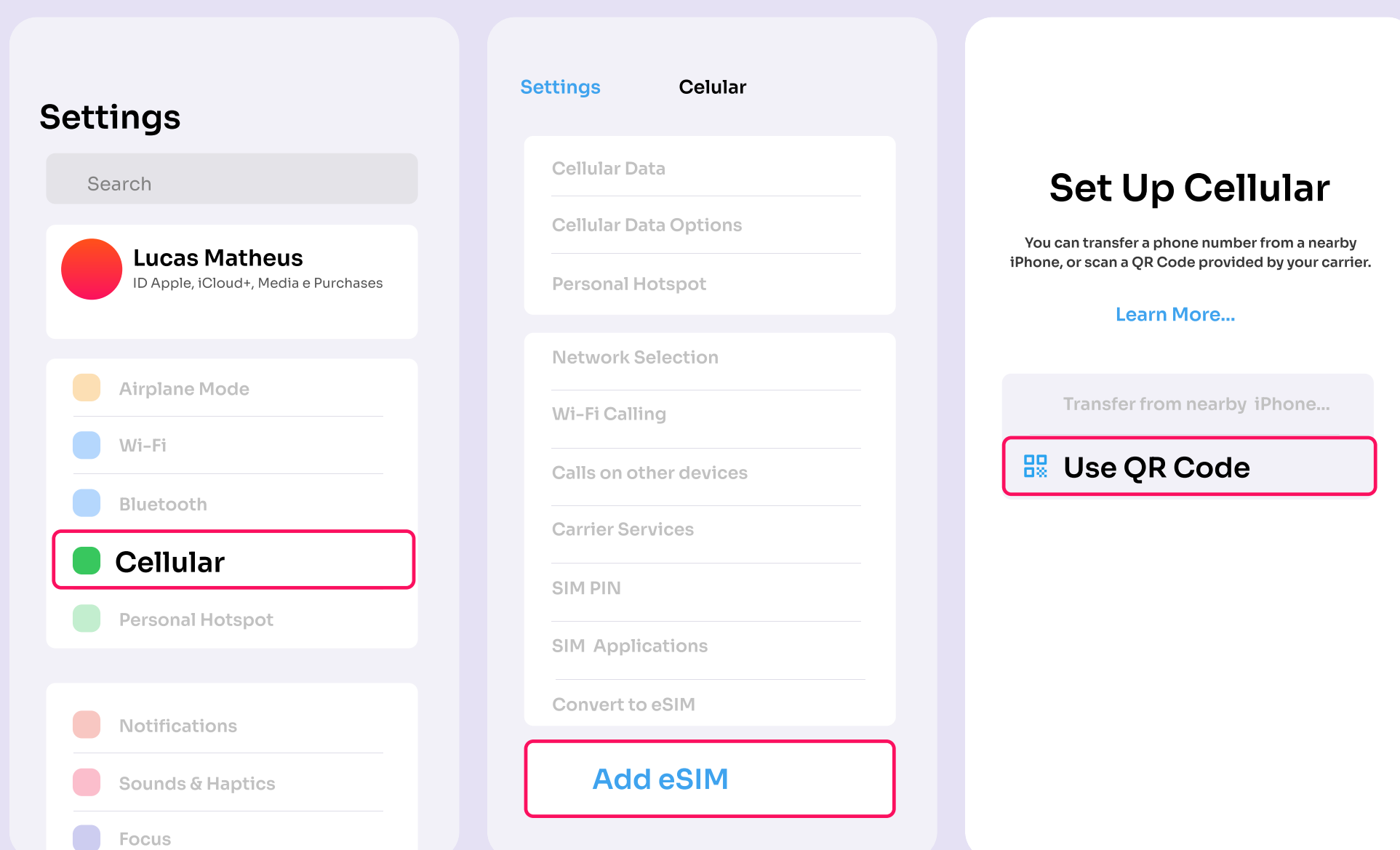

2 eSIM ACTIVATION

